

COLLECTORS NO. 40045

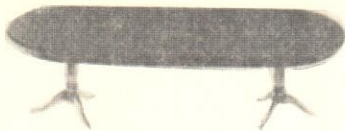

Chippendale Dining Table

Circa 1760



The overall design of this table is attributable to Thomas Chippendale, but the extensions and extra leaf were a modification made at a later time. Extension tables were extremely rare until late in the 18th and early 19th centuries.

The pedestal base allowed for the use of the heavier, broader chairs favored by Chippendale. The pedestal itself was often ornately carved, usually with a design featuring Acanthus leaves. The outcurved tripod legs were often carved in the same manner and were usually terminated in paw foot.

Due to the massive size of these tables, and the problems of storing them once they passed out of style, few have survived intact. Some were modified into smaller round tables utilizing the individual pedestals.

Mahogany, as in most of Chippendale's pieces, was the primary material used, however, cabinetmakers in America used a variety of native woods to construct similar tables. Carving on the apron was usually held to the minimum, but fancy grain veneer wasn't uncommon.

INTRODUCTION

BEFORE STARTING

Identify and account for each part by placing it on the Layout Sheet (make sure the correct layout sheet is used when working on multi-kit Instruction Sheets). Should any parts be missing, send a post card to:

THE HOUSE OF MINIATURES
Customer Service - Parts Dept.
2000 Craftmark Center
Statesville, NC 28677-2000

Please print Name, Address, Part Number (Number from Layout Sheet) and Kit Name and Number on card when ordering.

SANDING

Before assembly, sand all the outer surfaces of individual parts with 220 grit sandpaper, or finer, sanded in the same direction as the wood grain until the surface is smooth. Take care not to round any edges or corners of the pieces. Finish sanding with 280 grit sandpaper.

PRE-ASSEMBLY

A. After sanding, check the proper location and fit of each part by assembling parts loosely, without gluing. Use the **DETAIL VIEWS** as a guide.

B. All parts for X-ACTO kits are made on precision milling machines. When adjustments are required, sand to fit.

ASSEMBLY AND FINISHING INSTRUCTIONS



AUTHENTIC REPRODUCTIONS IN MINIATURE.

The X-ACTO® House of Miniatures® Collectors Series of furniture and accessories have all been carefully researched by specialists through major museum and library collections to assure the highest quality of authenticity in reproduction. Details are extraordinarily accurate to satisfy the most discriminating miniaturist.

All wood parts are machined to assure accurate and precise acceptance of each piece by another.

For a complete catalog of the X-ACTO® HOUSE OF MINIATURES furniture line and accessories, write to:

THE HOUSE OF MINIATURES
Customer Service - Catalog Dept.
80 Newbridge Road
Bergenfield, NJ 07621

TOOLS AND MATERIALS

A. The following tools will be helpful in constructing this kit:

1. Two-inch Sander, X-ACTO No. 7042
2. Large Clamp, X-ACTO No. 7004
3. Small Clamp, X-ACTO No. 7003
4. X-ACTO Professional Finishing Kit (or equivalent, see note)
6. X-ACTO Professional Finishing Kit (or equivalent, see note)

B. The following materials will be needed to construct this kit:

1. X-ACTO Tinted Glue (see note)
2. Sandpaper - 220 and 280 grit
3. Steel Wool - Grade 0000
4. Small Artist's Brush
5. White glue (or equivalent)
6. Small Artist's Brush.

NOTE: The X-ACTO tinted glue is matched to the finish used in the Professional Finishing Kit. This will produce the authentic finish of the period in which the original Furniture was produced. When not using X-ACTO glue follow manufacturer's directions.

GLUING

A. Glue should be applied in small amounts to surface being joined. When gluing dado joints apply glue to dado only.

B. To ensure a tight fit, squeeze excess glue out of the joints. Hold glued parts together with clamps, rubber bands or weights on the parts.

C. Wipe off excess glue promptly.

D. Be sure a glued assembly has dried thoroughly before adding parts.

FINISHING

The X-ACTO Professional Finishing Kit enables you to finish your furniture by the same process used by the professional furniture maker. The end result is what is important — there are easier methods, but none that will give the quality results that this process will. If you use a finish other than X-ACTO's, refer to the manufacturer's directions.

Layout Sheet

Kit 40045

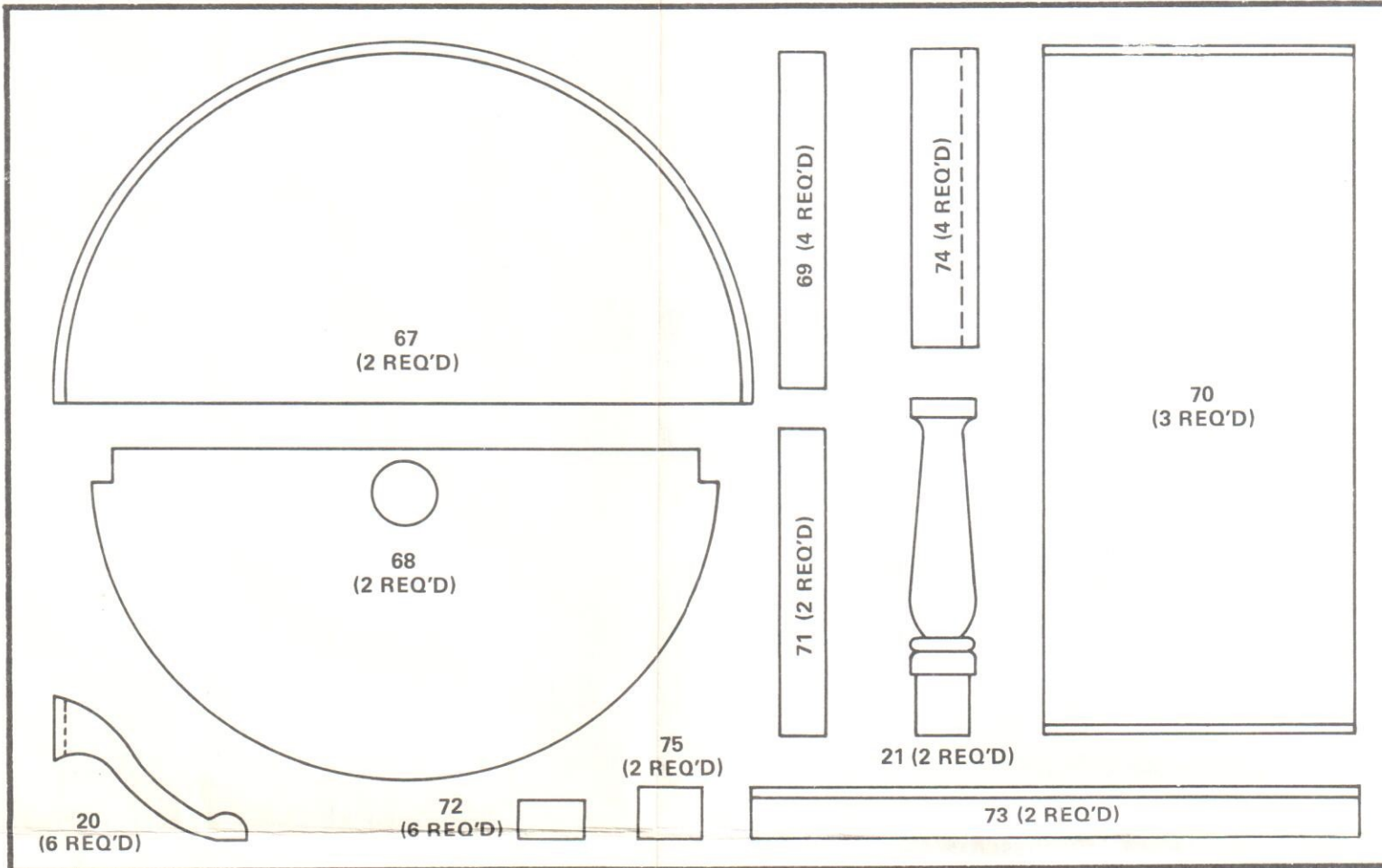

Step 1

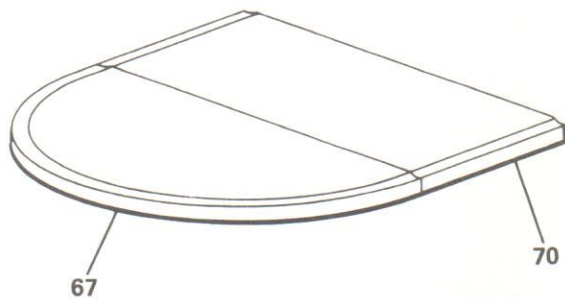

A. Glue top leaves (67) & (70) together. Make two sets, one for each end of table. Do not glue the two sets together. Sand joints smooth.

Step 2

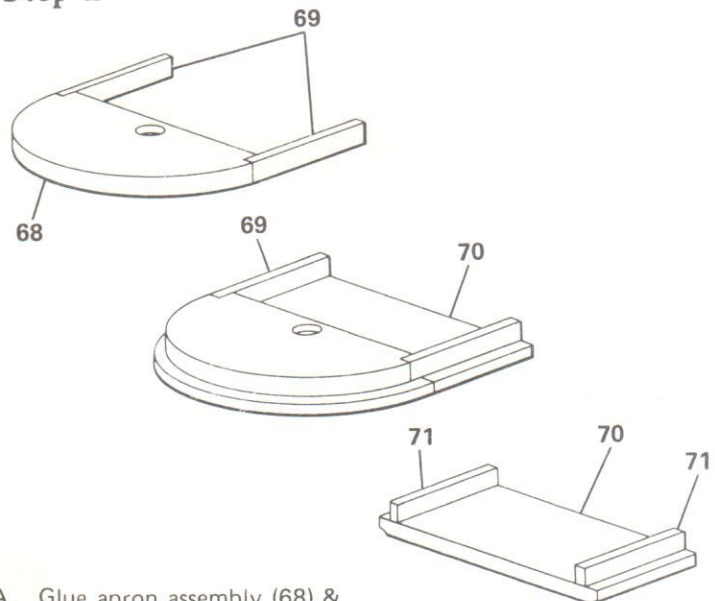

A. Glue apron assembly (68) & (69) together.

B. Glue apron assembly to top. Contoured edge of top should be towards the top of the table when this step is complete. End of side (69) should be flush with the edge of (70). Step C should be completed in conjunction with this step.

C. Glue apron sides (71) to center leaf (70). Sides (69) on both ends of the table top and sides (71) of the center leaf should all be aligned to form a straight apron.

Detail Views

Kit 40045

Step 3

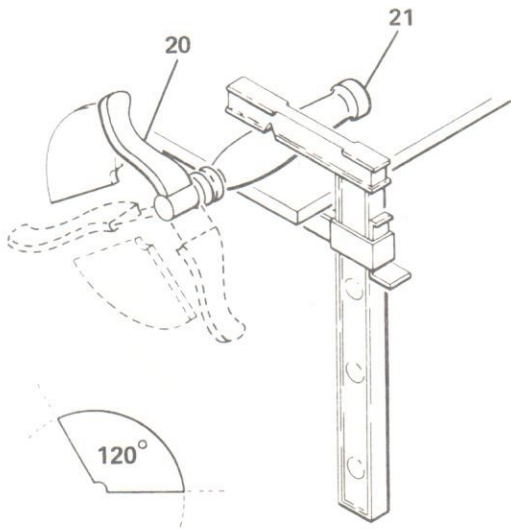

A. Clamp pedestal (21) to a flat surface. Glue leg (20) to the projection at the base of the pedestal. Allow to set properly. Using the 120° guide for proper spacing, glue on remaining two legs.

B. Repeat for other pedestal.

Step 4

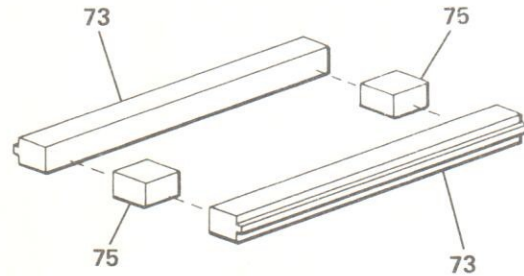

A. Assemble center slide by gluing spacers (75) between slides (73). Blocks should be flush with the ends of the slides. Sand so that top and bottom surfaces are flush.

Step 5

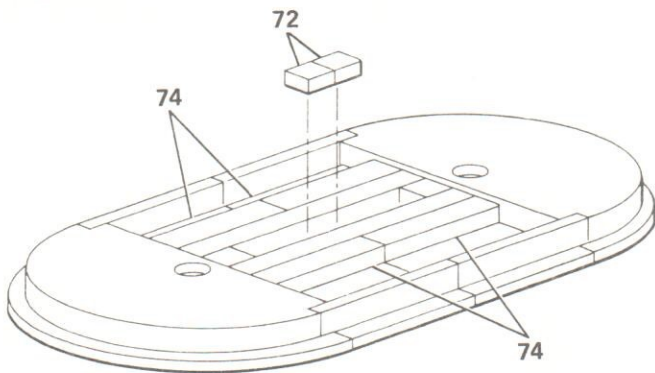

A. Place slide assembly made in Step 4 in center of table. Glue guide blocks (74) to under side of table so that they engage slide assembly lightly. Carefully pull table halves apart and remove slide assembly until glue is dry.

B. Stops (72) are installed after final finishing in the center of the slide assembly, against the center edge of the top, and are glued to the top only.

Step 6

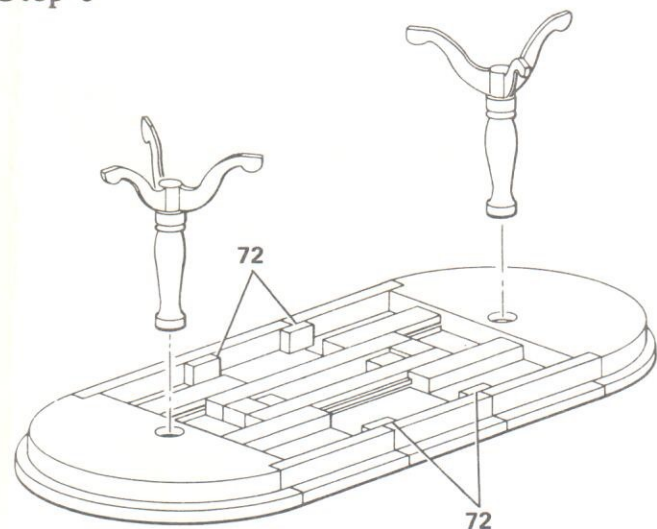

A. Align the two table halves and the center leaf. Glue two guide blocks (72) to the aprons of one table end so they overlap the leaf apron. Glue two blocks to the opposite side of the leaf apron so they overlap the apron on the other table half.

B. Install the pedestals in the

holes of the end aprons.

C. Remove slide assembly and apply final finish. Do not apply finish to the slide or to the grooves in the guide blocks. Candle wax or paraffin may be applied to the slide edges before final assembly for better operation of the slide.

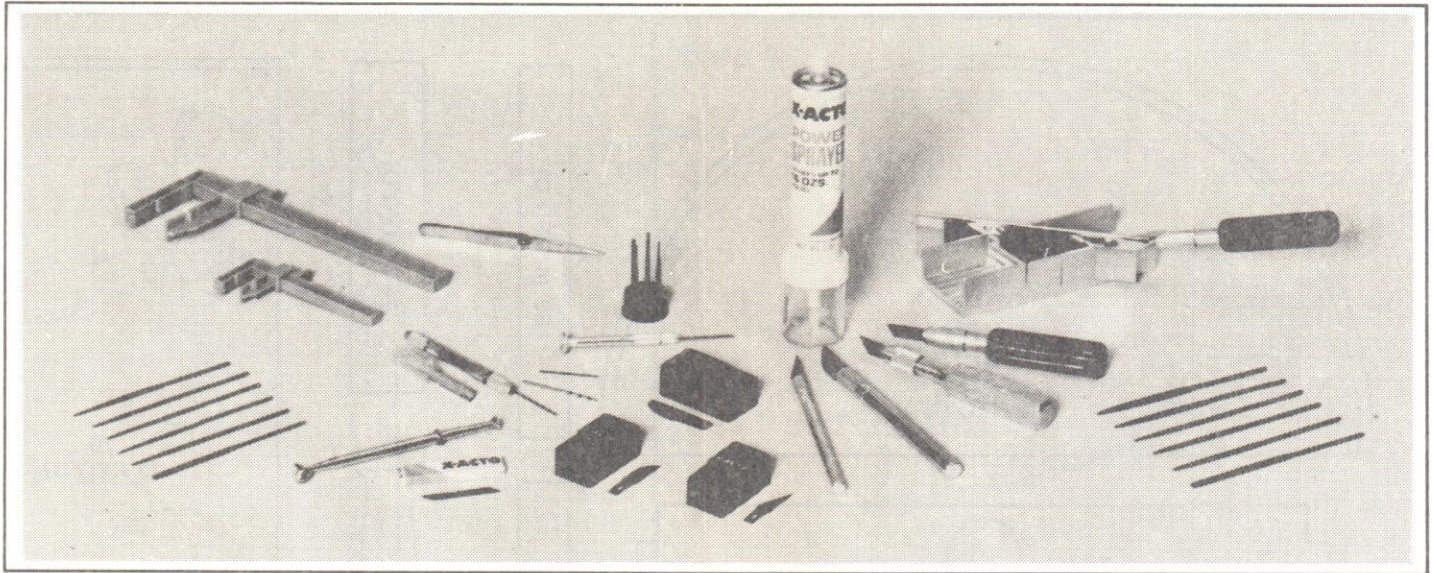

A. MINIATURE FILE SET

6 miniature needle files. 3 1/8" long. For intricate filing. Vinyl storage pouch. No. 7365

B. PLASTIC CLAMPS

Light duty plastic clamps for delicate work. Notched jaw allows grip of round parts. Smooth face prevents damage to workpiece.

Small plastic clamp. 3 1/4" opening with 1" throat depth. 2 per card: No. 7003

Large plastic clamp. 7 1/4" opening with 2 1/8" throat depth. 2 per card: No. 7004

C. SELF-CLOSING POINTED TWEEZER

Self-closing serrated points. Nickel-plated steel. 6 1/2." Carded: No. 7337

D. SCREWDRIVER WITH INTERCHANGEABLE BLADES

Aluminum handle and chuck and 5 steel screwdriver blades sizes .040" through .100." Notched shank for greater torque. Storage base. Carded: No. 7070

E. PIN VISE SET

Includes double-ended pin vise, vise bit guard and 3 assorted drill bits. Carded: No. 7144

F. PARTPICKER

For small hard-to-handle pieces. Smooth one-handed action. Carded: No. 7380

G. No. 13 BLADE

Precision saw cutting. 5 blades. Carded: No. 213

H. No. 10 BLADE

For fine general cutting, carving, correcting stencils. Safety dispenser of 10 blades. Carded: No. 410

I. No. 22 BLADE

General shaping, whittling, trimming, removing excess flashing. Safety dispenser of 10 blade. Carded: No. 422

J. No. 11 BLADE

Extremely sharp point for fine angle cutting and stripping. Safety dispenser of 10 blades. Carded: No. 411

K. No. 1 KNIFE

Aluminum handle 4 7/8" long with No. 11 blade. Carded: No. 3201

L. No. 2 KNIFE

Aluminum handle 5" long with No. 22 blade. Carded: No. 3202

M. No. 6 KNIFE

Aluminum handle 4 3/4" long with No. 24 blade. Carded: No. 3206

N. No. 5 KNIFE

Plastic handle with metal blade lock, 4 1/4" long with No. 19 blade. Carded: No. 3205

O. MINIATURE NEEDLE RASPS

6 assorted rasps. For rough shaping of wood or plastic. 4 3/4" long. Vinyl storage pouch. No. 7366

P. MITRE BOX

Aluminum 3/4" x 1 3/4" capacity. 6" long. With two 45° and one 90° cutting slots. Carded: No. 7533

Q. EXTRA-FINE RAZOR SAW

1 1/4" deep with cutting edge 5 1/2" long and 54 teeth per inch for extra fine precision. For use with No. 7533 mitre box. Carded: No. 7535

R. POWER SPRAYER

Push-button action sprays evenly. Includes a one ounce jar and propellant to spray on intricate or flat surfaces up to 16 ounces of liquid materials. Carded: No. 43561

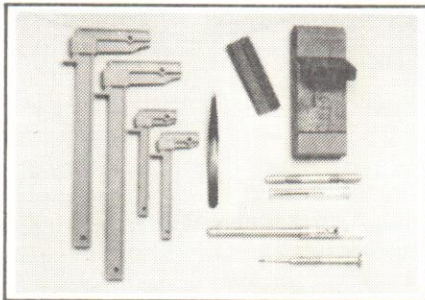

MINIATURIST'S TOOL SET

Basic tools for assembling miniatures, models and working with small parts. 4 clamps, tweezer, pin vise with 3 bits, 2 sanders, screwdriver and No. 1 Knife in fitted tray. No. 43910

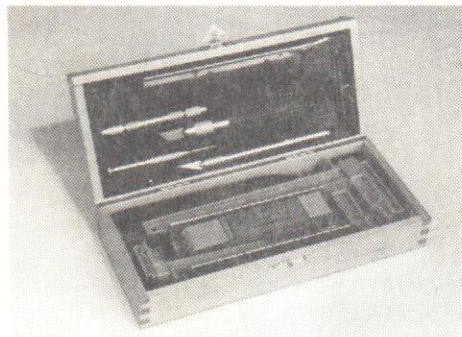

DELUXE MINIATURIST'S TOOL CHEST

Fitted wooden chest contains precision tools for assembling miniatures, models and working with small parts: razor saw blade, mitre box, 4 clamps, pin vise and 3 bits, Nos. 1 and 5 Knives, sanders and screwdriver. Boxed: No. 43911